

# RFRE

## RF REMOTE EXTENSION

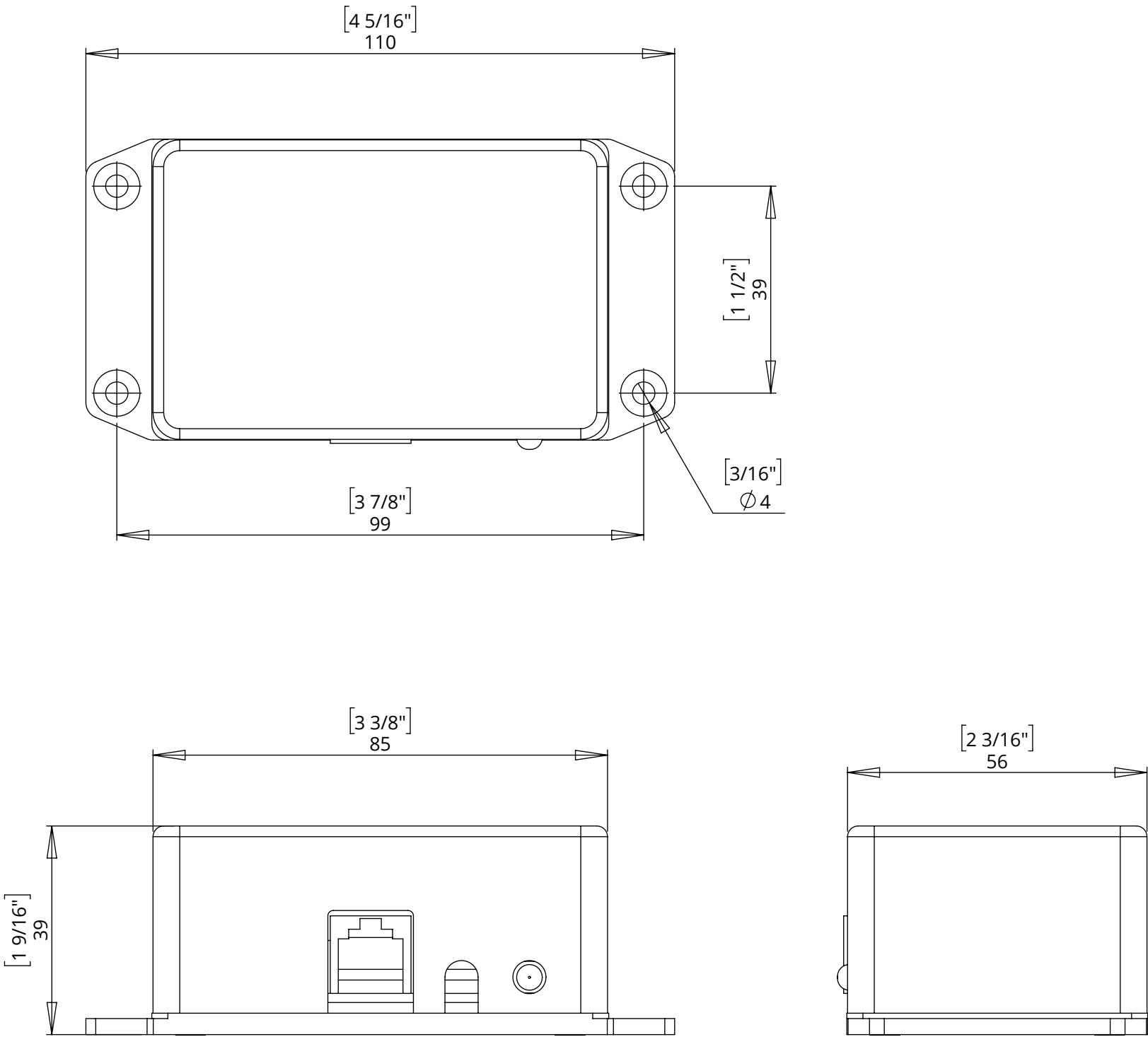

future automation

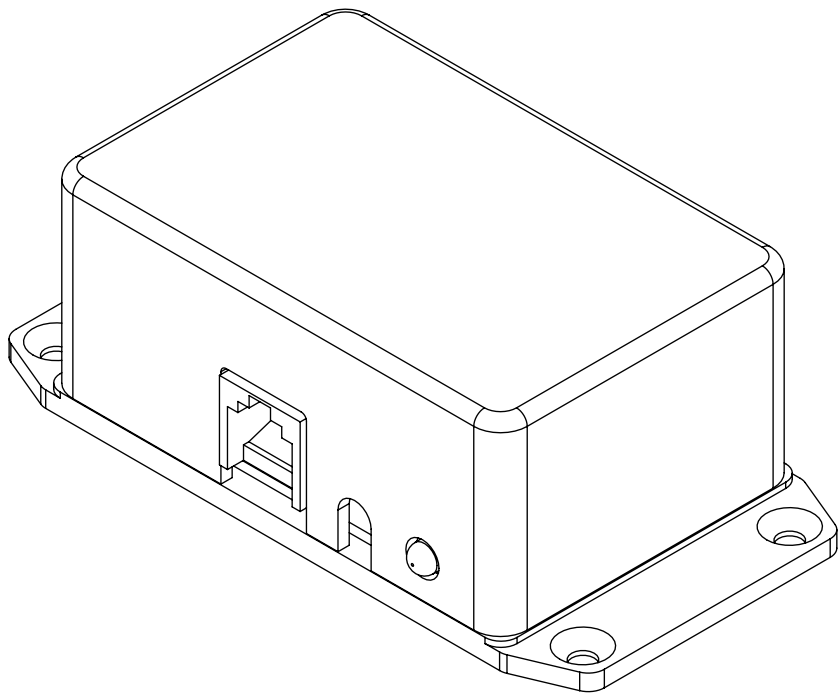

# RFRE

## RF REMOTE EXTENSION

### ADDING AND CONTROLLING THE RF REMOTE EXTENSION

Blue LED flashes on controller to indicate when buttons are activated. If no light comes on when buttons are pressed it may be that the battery is faulty or empty.

Keys on RF controller work in sync with mechanism's contact closure. Refers to mechanism contact closure in the mechanism instructions.

- 1 - Use the extension port on the RF control box for any additional contact closure inputs to the control box.
- 2 - The RF control box will now act as the receiver from the remote and relay the relevant information into the control box.

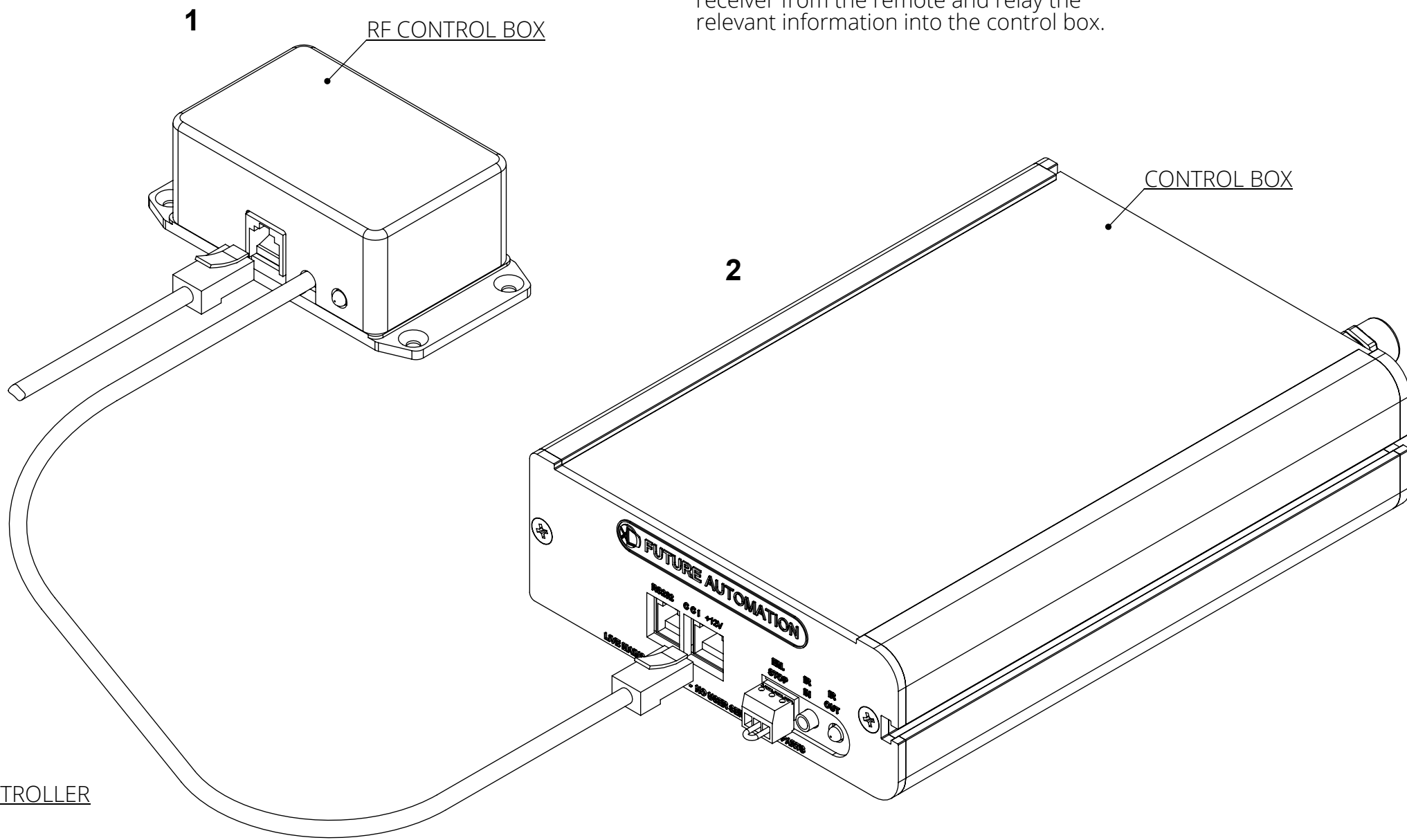
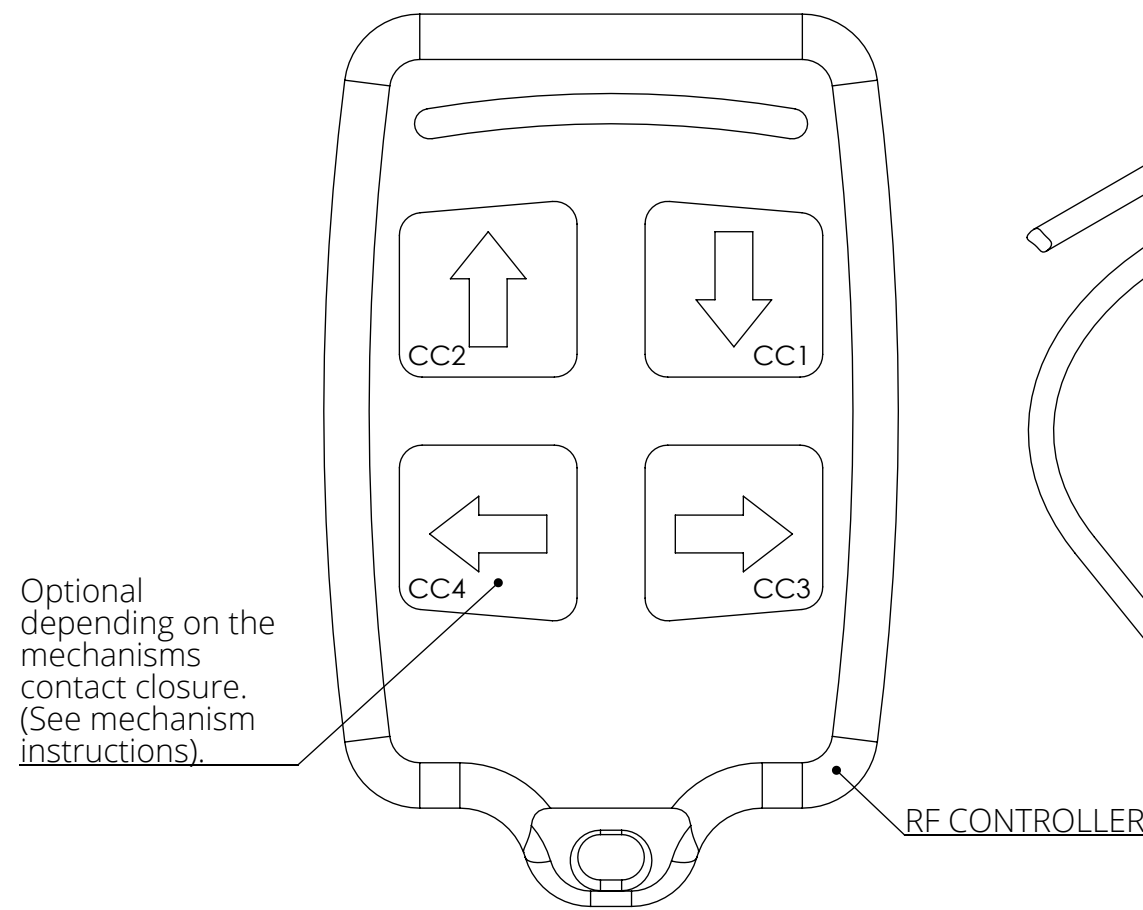

# RFRE

## RF REMOTE EXTENSION

### PAIRING A NEW CONTROLLER

To pair a new controller to the RF extension box remove the outer casing by removing the screws from the base.

Press the white pairing button shown until the pairing sync LED starts flashing.

Finally press any button on the new RF controller to sync with extension box.

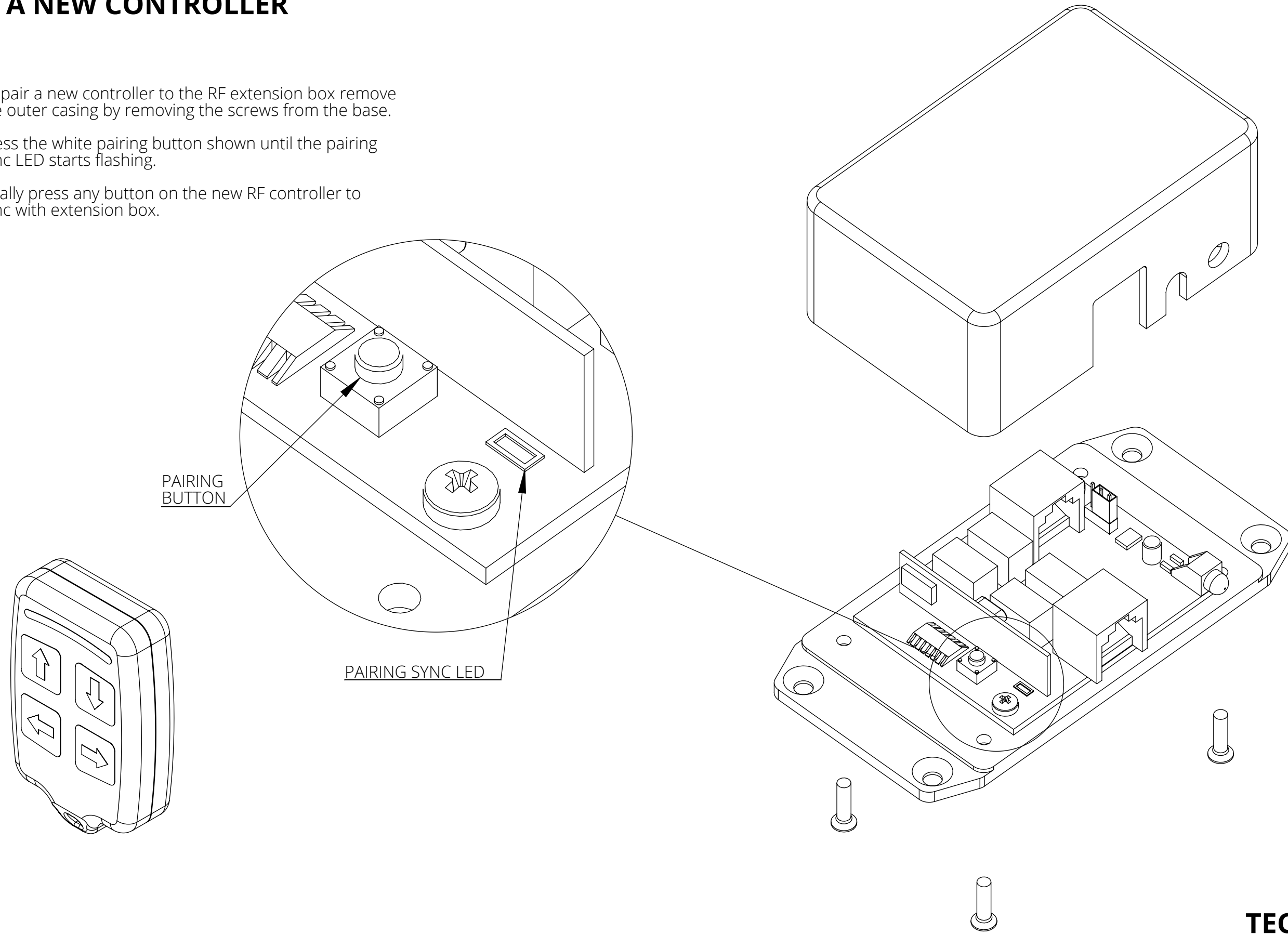

# RFRE

## RF REMOTE EXTENSION

### RF COMMAND OUTPUT

Linking these connector pins allows CC4 or CC5 to be used.  
Either command will be activated using CC4 button on the RF controller.  
As default the board is set up to CC4.

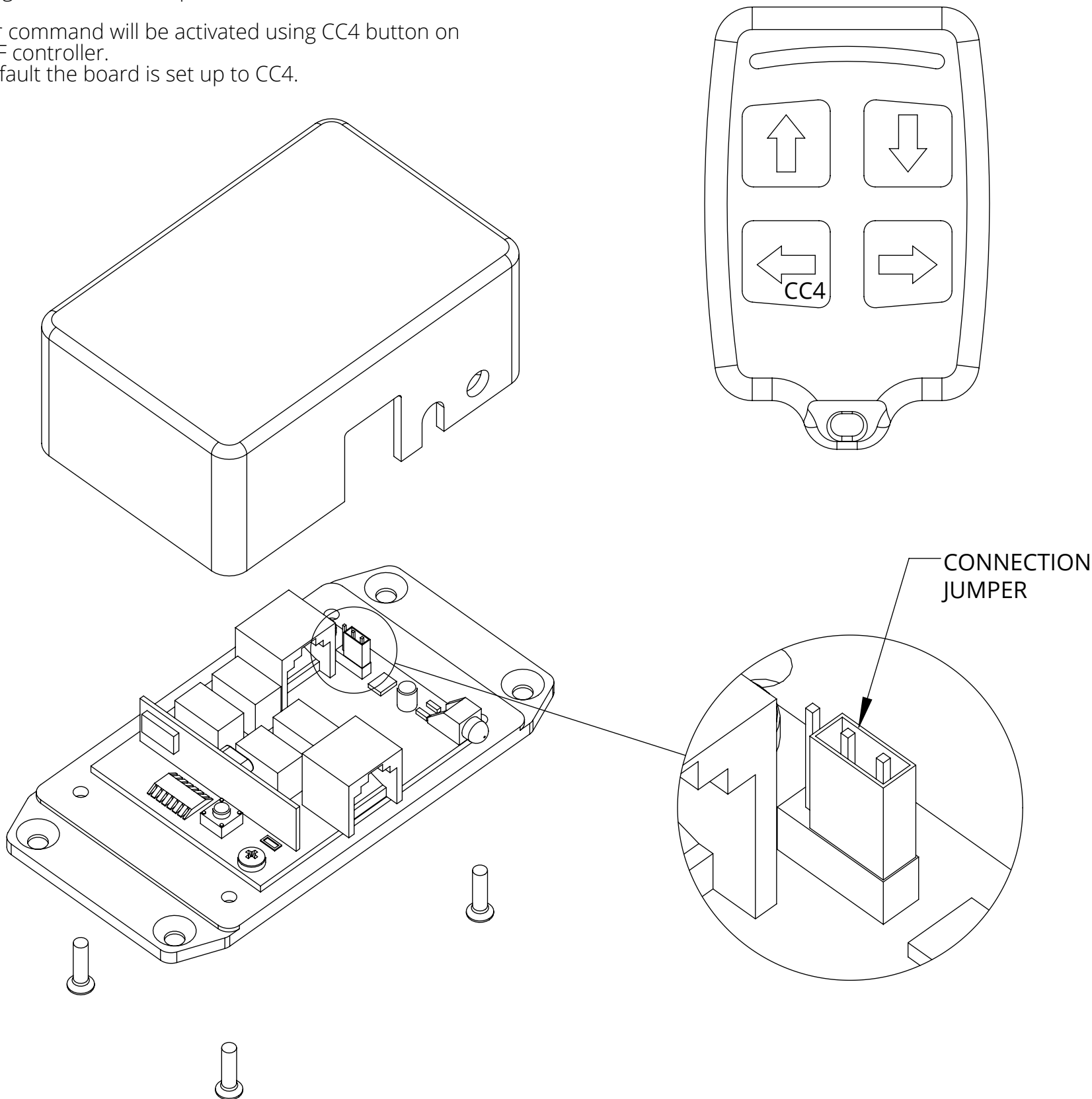

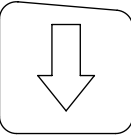
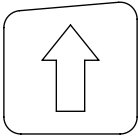
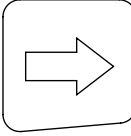
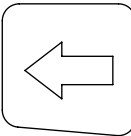
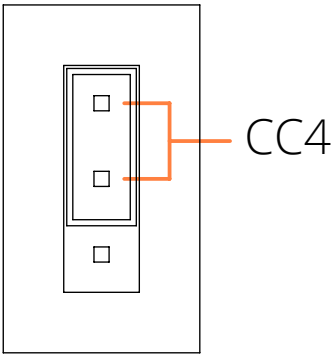
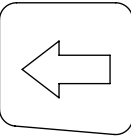
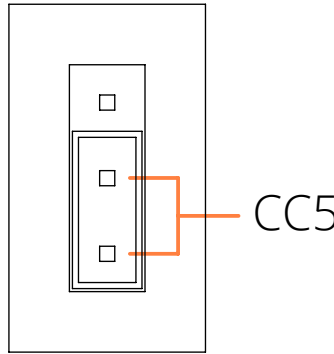
	<b>CC1</b>	Contact Closure 1 IN command issued
	<b>CC2</b>	Contact Closure 2 OUT command issued
	<b>CC3</b>	Contact Closure 3 STOP command issued
 	<b>CC4</b>	Contact Closure 4 command issued *
 	<b>CC5</b>	Contact Closure 5 command issued *

\* See specific product instructions for command details